



X-Pack Flat Upgrade

Retrofit Kit

Product Highlights

- X-Pack Flat Upgrade is a customized solution for upgrading an analog system into a digital RAD system
- X-View S is a professional acquisition software for X-ray images from flat panel systems (DR) and CR units (computed radiography with imaging plates) by any manufacture
- The software controls X-ray generators and X-ray units of various manufacturers, providing a smooth and systematic workflow
- Compatible with a wide range of flat panel detectors
- Adaptable to oscillating and removable grid
- Advanced application with a five field invisible measuring chamber



Customized Scope of delivery

Depending on the current status of the existing analogue system, you can choose between the complete X-Alliance component portfolio. The standard package includes the following components:

X-Pack Flat Upgrade Standard	
X-View S	Image Acquisition software • Incl. Monitor, PC
X-Flat 1717	17"x17" Detector System • Receptor type: Amorphous Silicon TFT or Selenium • Scintillator: Gadolinium (Gd2O2S) or CsI
X-Tray	• Bucky unit for diverse detector sizes • Adaptable to fix and oscillating, removable grids
Smit Röntgen X-Ray Grid	• Oscillating and removable grid • Fiber interspacer allows maximum grid performance at reduced X-ray dose • Light in weight carbon fiber for lowest inherent filtration and • Compatible to X-Tray (bucky unit)
5-Field Amplimat Chamber	Automatic Exposure Chamber • 5 invisible measuring fields • kV range: 40-150kV • Exposure time range: 1ms-6s
Sync Box	X-Sync • Sync box with low/high active +12V/24V allows to adapt to any generator in the field
X-Pack Cable Set	• 400V • SUB D9 signal cable 30m • Collimat M cable set • Cable set RO/SRO/DR 18xx (stator, thermo, earth)

X-Pack Flat Upgrade Options Hardware

X-Pack Flat Upgrade Options Hardware	
Epsilon	X-Ray Generator • 50kW X-ray generator (options from 50-80kW) • Ultra high frequency up to 240kHz X-ray generator designed with a unique power inverter technology for later upgrading in the field • Adaptable to most (>100) existing tubes • Solid state high voltage modules (no oil) permitting small dimensions (472mmx768mmx812mm) & reduced weight (79-90kg)
Highflex KKG	High Voltage Cable • Variable in length
X-Ray Tubes	Dunlee DU/DR • DR1817 Philips • RO17/50 or SRO 33/100 • Other tubes up on request
Collimat M	• Modular customization design concept • Highest light density in the market with Power LED technology • Guarantees a lifetime of more than 10 years

Options for Upgrading X-View S Software

X-View S may not only be used as software for the acquisition and processing of X-ray images, but can also be upgraded to a Mini PACS or even a Enterprise Multi Modality PACS.

X-View S Software Upgrade Options	
DICOM Reception	From any DICOM sources, e.g. CT, MRI, scintigraphy, ultrasound etc
DICOM Distribution	With freely configurable rules
DICOM DIR Import	For archiving patient CDs by other manufacturers
DICOM Query/Retrieve	SCP/SCU
DICOM Auto	Pre-fetching
DICOM Print Server	To convert DICOM Basic Print into Windows print jobs
DICOM Compression	According to freely configurable rules
DICOM CD/DVD Backup Module	Also via robot systems
Integration of Scanners	Film and document scanners
Signal Digitalization	Standard and non-standard video signals, e.g. endoscopy, angiography etc
Fully Automatic Synchronization	Of two image databases, e.g. laptop and main archive
Exchange of Images and Diagnostic Reports	E.g. between individual clinics by means of teleradiology
Web Server Intranet	Distributes images within a hospital and displays the images in a web browser
Web Server Internet	Enables worldwide image distribution to referring doctors and patients via internet

Further options for upgrading X-View S software are available

Operation mode for Bucky table and wall stand

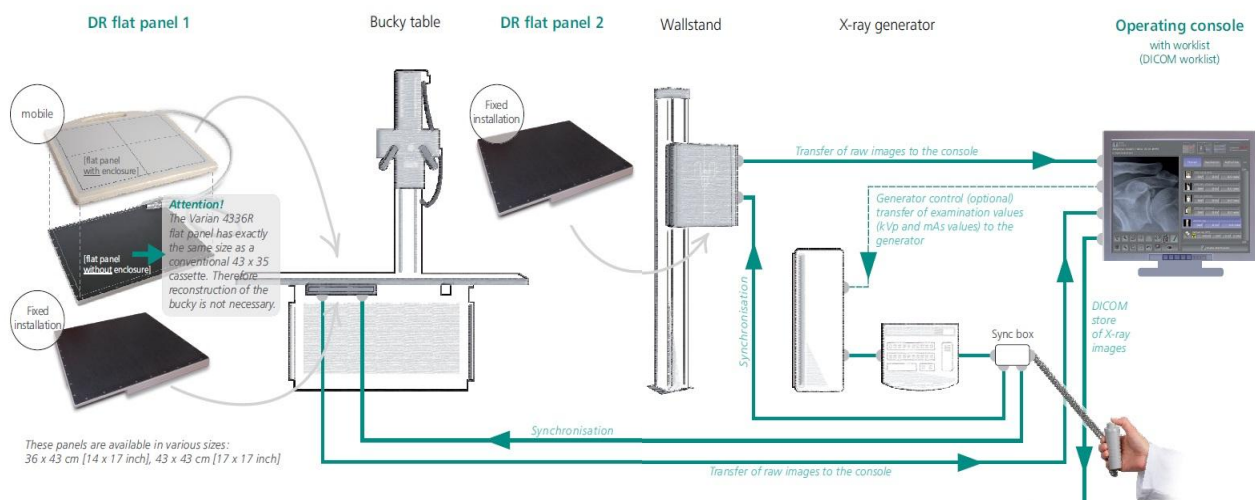

Get to know X-View S Software

X-Alliance provides a **free demo version**, **user manuals** as well as **technical manuals** of the X-View S Software. If you would like to get an impression please visit our website:

<http://www.x-alliance.com/admin/login>



Your login data is:

Username: **customer**

Password: **xallocust**

X-Pack Flat Upgrade

- ... for almost any existing X-ray system
- ... various sizes and types of flat panel detectors
- ... integrated solution: generator control & examination data
- ... superior image quality: oscillating grid
- ... advanced application: non-visible 5-field measurement chamber